

Massachusetts Department of Conservation and Recreation
Division of Water Supply Protection, Office of Watershed Management
Forest Management Project Summary

Project Title: Pine Plains Rd

DWSP Harvest Permit Number: 4392
DCR Forest Cutting Plan File Number: 257-8447-17

Site Information

Watershed: Ware River Watershed	Town(s): Rutland
Acres: 8.1	Nearest Road: Pine Plains Rd
Natural Heritage Atlas overlap?: No	Public Drinking Water Supply Watershed?: Yes
Forest Types: White Pine/Hardwood	ACEC?: No
Soils: 253 C Hinckley loamy sand 8-15% slopes excessively drained, and 254 B Merrimac fine sandy loam 3- 8% slopes somewhat excessively drained	
Wetland Resources: Wetlands and a stream are present, adjacent to but outside of harvest area.	
Vernal Pools present or within 200 feet of harvest : None Known	

Harvest Information

Harvest Start Date: After 12/16	Harvest End Date: 5/25/17
Number of Wetland Crossings: None	Number of Stream Crossings: None.

Best Management Practices Applied

Stream Crossings	There are no stream crossings.
Filter Strips	There is no harvesting in filter strips.
Wetland Crossings	There are no wetland crossings.
Harvesting in Wetlands	There is no harvesting in wetlands.

DWSP Forester supervising this harvest
Name: Ken Canfield
Forester License # 431
Phone #: 508-882-3636 X 1603
Email: kenneth.canfield@state.ma.us

NARRATIVE

General Description/Forest Composition/History:

This area was used as pasture land until the 1930's. The 1938 aerial photos show that white pine was already established on areas with a little bit of slope, while the flat areas are completely open. The white pine started under these conditions is very low quality.

Overstory tree species diversity is relatively low. The harvest area is dominated by low quality "old pasture" white pine trees that are 80+ years old. Although there are scattered red and white oak, red maple, hemlock, and pitch pine trees, they make up a very low percentage of overstory trees. Advanced regeneration of all species except pitch pine is present, and is much more balanced in terms of diversity.

Site Selection:

The primary goal of the watershed forest management program is to create and maintain a forest that provides high quality drinking water to current users and future generations. DWSP recognizes that wildlife habitat management and restoration of rare habitats are important secondary goals, where they are compatible with maintaining high quality drinking water.

This area was specifically targeted because there is a 25 + acre stand dominated by poorly formed pasture white pine. That type of stand is relatively low in diversity of overstory tree species. The white pine trees that are present are also more prone to windthrow in a wind event because they are tall and multi-stemmed. The abundant advanced regeneration present consists of a more balanced species mix, and makes it more likely that the resulting stand will be established quickly and will be more diverse.

Silvicultural Objectives:

The silvicultural objective for this lot is to regenerate 8.1 acres of old pasture white pine stand to a more diverse stand with a higher percentage of dominant or co – dominant hardwood species, especially oak. This will be done in four groups that are 0.6 acres, 1.2 acres, 1.4 acres, and 4.9 acres in size.

Cultural Resources:

This land has been determined to not be culturally or archeologically sensitive based on a review by the DCR Archaeologist. Standard practice dictates that every effort is made to avoid disturbing stone walls and other cultural resources.

Wildlife/Rare or Endangered Species:

No known vernal pools are present within the lot or within 200 feet of the boundary of the lot.

FIGURES

Figure 1 Final Forest Cutting Plan

Figure 2 A-E Pre-Harvest photographs from marked photo points 1 (A-C) and 2 (D & E) taken 1/19/17

Figure 3 A-E Post-Harvest photographs from marked photo points 1 (A-C) and 2 (D & E) taken 5/24/17

Figure 1: Forest Cutting Plan

Forest Cutting Plan

and Notice of Intent under M.G.L.
Chapter 132 - The Forest Cutting
Practices Act, 304 CMR 11.00 **NOV 03 2016**
(Effective Date: 1/1/04)

For DCR Use Only:

File Number 27-847-11 Case No. _____
Date Rec'd 11/3/16 Nat. Hert. NO
Earliest Start 11/15/16 Nat. Hert. Imp. N/A
River Basin Chapin Pub. Dr. Wat. State River
Gen. Obj. LT ACEC NO

Site Information

Location marked 11/18/16

Town Rutland
Road Pine Plains Rd
Acres 8.1 Proposed Start Date 11/16
Vol. MBF 17.1 Vol. Cds. 28 Vol. Tons 559

Plan Preparer

Name Kenneth W. Canfield
Address 578 Old Turnpike Rd

Town, State, Zip Oakham, MA 01068
Phone (508) 882-3789 X 1603

Type of Preparer LF
*Mass. Forester License # 431

*Required for land under Ch61, Ch61A or Forest Stewardship

Landowner

Name DCR, Division of Water Supply Protection
Mailing Address 485 Ware Rd

Town, State, Zip Belchertown, MA 01007
Phone (413) 323-6921

Ch61 61A 61B Stew *Case # _____
CR CR Holder _____

Licensed Timber Harvester**

Name _____
Address _____

Town, State, Zip _____
Phone _____

Mass. Lic. Harvester # _____
**This information may be supplied after the plan is approved, but before work begins.

Best Management Practices

Stream Crossings

Indicate location on map	SC-1	SC-2	SC-3	SC-4
Type of Crossing				
Existing Structure				
Type of Bottom				
Bank Height (ft)				
Stabilization				

Wetland Crossings

Indicate location on map	WC-1	WC-2	WC-3	WC-4
Length of Crossing				
Mitigation				
Stabilization				

Filter Strips

Indicate location on map	FS-1	FS-2	FS-3	FS-4
Width (50', 100', or VA)				

Harvesting in Wetlands

Indicate location on map	HW-1	HW-2	HW-3	HW-4
Forest Type (see pg 2)				
Acres to be Harvested				
Resid. Basal Area (>50%?)				

Service Forester Comments

Please notify DCR Service Forester when harvest begins

Codes

Type of Preparer	Type of Crossing	Stabilization	Mitigation	Type of Bottom	Note
LF Mass. Lic. For.	CU Culvert	SE Seed	FR Frozen	LE Ledge	Note: Applicant must provide DCR with all relevant information before plan may be approved and cutting may begin. Some forestry activities, such as prescribed burning and pesticide or fertilizer application may require additional permits. Consult MA Forestry BMP Manual for further information.
TH Lic. Tim Har.	BR Bridge	MU Mulch	DR Dry	ST Stony	
TB Timber Buyer	FO Ford	CO Corduroy	OT Other	MU Mud	
LO Landowner	PO Poled	ST Stone		GR Gravel	
OT Other	OT Other	HB Hay Bales		OT Other	
		OT Other			

If Other (OT) is used in any category an explanation must be given on an attached narrative page

Forest Products

Products to be Harvested*

Species	Mbf/Cds		Mbf/Cds
White Pine	16.9 M	Red Maple	
Red Pine		Sugar Maple	
Pitch Pine		Red Oak	0.2 M
Hemlock		Black Oak	
Spruce		White Oak	
Other Hdw.		Other Hdw.	
White Ash		Total Mbf	17.1
Beech		Cordwood (Cds)	28
White Birch		SW Pulp (Tons)	
B & Y Birch		HW Pulp (Tons)	
Black Cherry		Chips (Tons)	559

*Note: Volumes and values indicated in the Plan are as reported by the plan preparer and have not been independently verified by the service forester upon approval. Mbf = thousand board feet.

Stand Treatment

Cutting Standards

Indicate location on map	ST-1	ST-2	ST-3	ST-4
Forest Type	WI	WI		
Acres	3.2	4.9		
Landowner Objective	LT	LT		
Designation of Trees	CT	CT		
Type of Cut	SE	CC		
Source of Regeneration	SE	SE		

Landowner

Landowner Signature

The most important information on a cutting plan is the Landowner's objective, as this will determine which trees will be harvested and which will remain; this decision will also determine the future condition of the forest for decades to come. After having read the Massachusetts Forest Cutting Plan Information Sheet on page one, indicate your objective by checking the appropriate box below.

LT - Long-term Forest Management

Planned management of the forest to achieve one or more of the following objectives: produce immediate and maximize long-term income, enhance wildlife habitat, improve recreational opportunities, protect soil and water quality, or produce forest specialty products.

ST - Short-term Harvest

Harvest of trees with the main intention of producing short-term income with minimal consideration given to improving the future forest condition, which often results in a forest dominated by poor quality and low value species.

I (we) have read the Massachusetts Cutting Plan Information Sheet, and am aware of my (our) management options.

I (we) hereby certify that I (we) have the legal authority to carry out the operation described above.

I (we) certify that I (we) have notified the Conservation Commission in the town in which the operation is to take place and the abutters of record within two hundred feet of the area to be harvested.

I (we) understand that the volumes and values (Ch6) only in this plan have not been independently verified by the service forester upon approval and will report final values and volumes to the Director or his/her agent if the final figures differ from those reported.

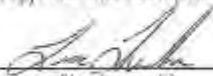
Signature of landowner(s)

10/31/16
Date

Service Forester

Determination and Status

Approved Disapproved Expires 11/30/18

Signature of Service Forester/Director's Agent

11/7/2016
Date

Extension: 1 2 Expires: 1 Ser. For. Ints: 1

Amendment: App 1 Dis 1 App 2 Dis 2

Final Report and Comments

I hereby certify that the afore described Forest Cutting Plan and all relevant statutes have been substantially complied with.

Signature of Service Forester/Director's Agent

1/15/17
Date

Site visit completed and landing area + skid trails were stabilized

Codes

Forest Types	HK Hemlock	OM Mixed Oak	Designation of Trees	CT Cut Tree	Type of Cut	SH Shelterwood	Intermediate Harvests:	Source of Regeneration
WP White Pine	HH Hem/Hdw	RM Red Maple	LY Leave Tree	ST Seed Tree	SE Selection	CT Commercial Thin	AD Advoicat	AD Advoicat
WK WP/Hem	BC Black Cherry	BE Beech	SB Stand Boundary	CC Clear Cut	SA Salvage	NT Non Com Thin	SE Natural Seed	SE Natural Seed
WH WP/Hdw	BB Bee/Bir/Map	SP Spruce/Fir	OT Other	SE Selection	SA Salvage	DE Diameter Limit*	PL Plant	PL Plant
WO WP/Oak	OH Oak/Hdw	SM Sugar Maple	Landowner Objective	SA Salvage	SA Salvage	OT Other*	CO Coppice	CO Coppice
RP Red Pine	OR N Red Oak	PP Pitch Pine	LT Long-term Mgt	SN Sanitation	DE Diameter Limit*		DS Direct Seed	DS Direct Seed
SR Red Spruce			ST Short-term Har		OT Other*		OT Other	OT Other

*If Other (OT) or a non-standard system is used an explanation must be given on attached narrative page

Forest Cutting Plan

Narrative Page (Effective Date: 1/1/04)

Use this page to provide further explanation or if Other (OT) was used in any category on pages 3 or 4.

Landowner MA DCR, DWSP

Town Rutland

File Number 257-8447-17

BMPs

Use this Section to provide further explanation or if Other (OT) was used in any category in the Best Management Practices Section on Page 3.

Stand 1 is a white pine/hardwood stand dominated by low quality overstory white pine. Three group selection cuts of 0.6, 1.2, and 1.4 acres will be harvested, retaining 5 to 10 square feet of basal area per acre of co-dominant trees, mostly red and white oak where present, also pitch pine, white pine and black cherry. Stand 2 is a white pine hardwood stand that is dominated by low quality overstory white pine. A 4.9 acre clearcut will be harvested retaining 5 to 10 square feet of basal area per acre of co-dominant trees, mostly red, white, and black oaks, also pitch pine, white pine, black cherry, and eastern hemlock.

Designation of Trees

Use this Section to describe the types of trees to be harvested and/or retained if Other (OT) was used for "Designation of Trees" in the Stand Treatment Section on page 4.

Stand No.	Species to be Cut	Size of Trees to be Cut	Quality of Trees to be Cut	% BA/Acre Removed

Regeneration & Future Condition

Use this Section to describe how Chapter 132 requirements will be met if a non standard system (HG, DL, or OT) was used for the "Type of Cut" in the Cutting Standards Section on page 4.

Stand No.	Source of Regeneration (ex. AD, SE)	How will Regeneration be obtained/protected? If using AD - Describe the species present and how the regeneration will be protected If using SE - Describe the source of the seed and the number of seed trees/acre

Stand No. **Desired Future Condition**
Describe what the stand is expected to look like five years from the harvest, including the condition of the overstory & understory

Lot # 4392
Pine Plains Rd, Rutland
8.1 acres
MA DCR DWSP
Map by Kenneth W. Canfield
10/27/16
Not a legal survey

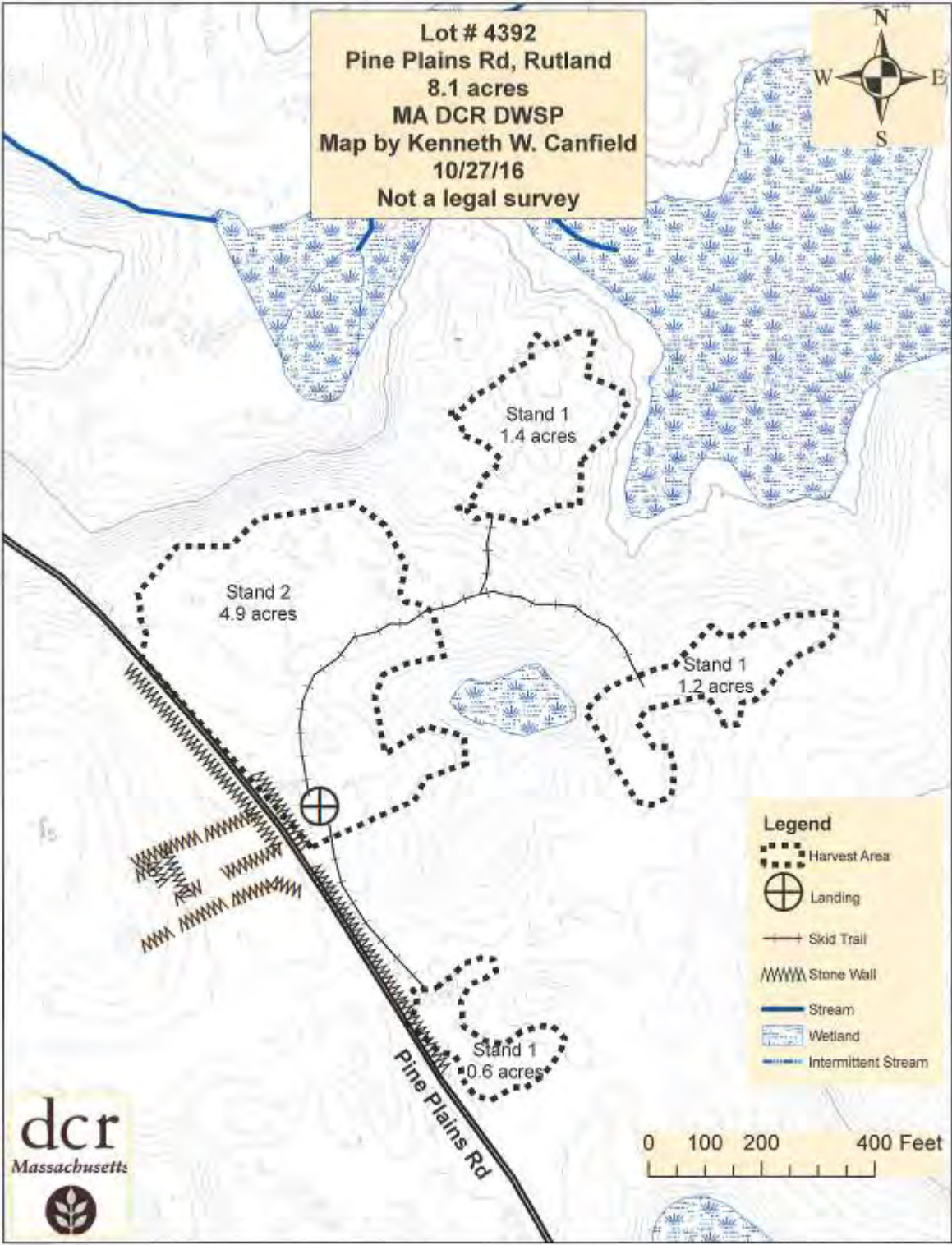

- Legend**
- Harvest Area
 - Landing
 - Skid Trail
 - Stone Wall
 - Stream
 - Wetland
 - Intermittent Stream

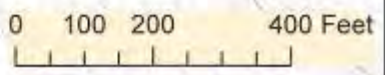

Lot # 4392
Pine Plains Rd, Rutland, MA
8.1 Acres
MA DCR
Division of Water Supply Protection
Prepared by Kenneth W Canfield 10/28/16
Data Sources: MassGIS, DCR & EOEEA
Not a legal survey



Legend
Harvest Area
Property Boundary



Department of Conservation & Recreation

1 Inch = 2,000 Feet
0 800 1,800 2,400 3,200 4,000 Feet

dcr



COMMONWEALTH OF MASSACHUSETTS
Department of Conservation and Recreation
Division of State Parks and Recreation

FILE # **257-8447-17**

FOREST CUTTING PLAN CERTIFICATE

Post this in a conspicuous place within the area in which the harvesting operation is to take place.

This certifies that **DWSP** **485 Ware Rd Belcher town** in accordance with the
(Name of Owner) (Address) **MA 01007**

provision of M.G.L. Chapter 132, Section 40-46, filed in **Clinton** with the Dept. of Conservation
and Recreation, Division of State Parks and Recreation, a Notice of Intent to cut forest products upon the

Pine Plain Rd lot.

Approval Date **11/17/16**
Director's Agent **Kate Margurs**
DCR Phone No. **(413) 992-8734**

ISSUED BY:

Priscilla E. Geighs, Director
Division of State Parks and Recreation

Figure 2 A-E: Pre-Harvest Photographs taken from marked photo points 1 (A-C) and 2 (D & E) taken 1/19/17

A. Point 1 taken 1/19/17



B. Point 1 taken 1/19/17



C. Point 1 taken 1/19/17



D. Point 2 taken 1/19/17



E. Point 2 taken 1/19/17



Figure 3 A-E Post-Harvest photographs from marked photo points 1 (A-C) and 2 (D & E) taken 5/24/17

A. Point 1 taken 5/24/17



B. Point 1 taken 5/24/17



C. Point 1 taken 5/24/17



D. Point 2 taken 5/24/17



E. Point 2 taken 5/24/17

